

TLR-275 Trailer Hitch. Fitment and build instructions.

<u>PARTS LIST</u>			<u>QTY</u>
1.	1520/4951	Pin, Washer, Hub cap	2
2.	1352	Wheel assembly	2
3.	TLR275/03	Axle assembly	1
4.	TLR275/02	Drawbar (rear section)	1
5.	TLR275/01	Drawbar (front section)	1
6.	12156	Ball hitch swivel	1
7.	2356	Ball hitch or clevis	1
8.	13080	Ring Hitch	1

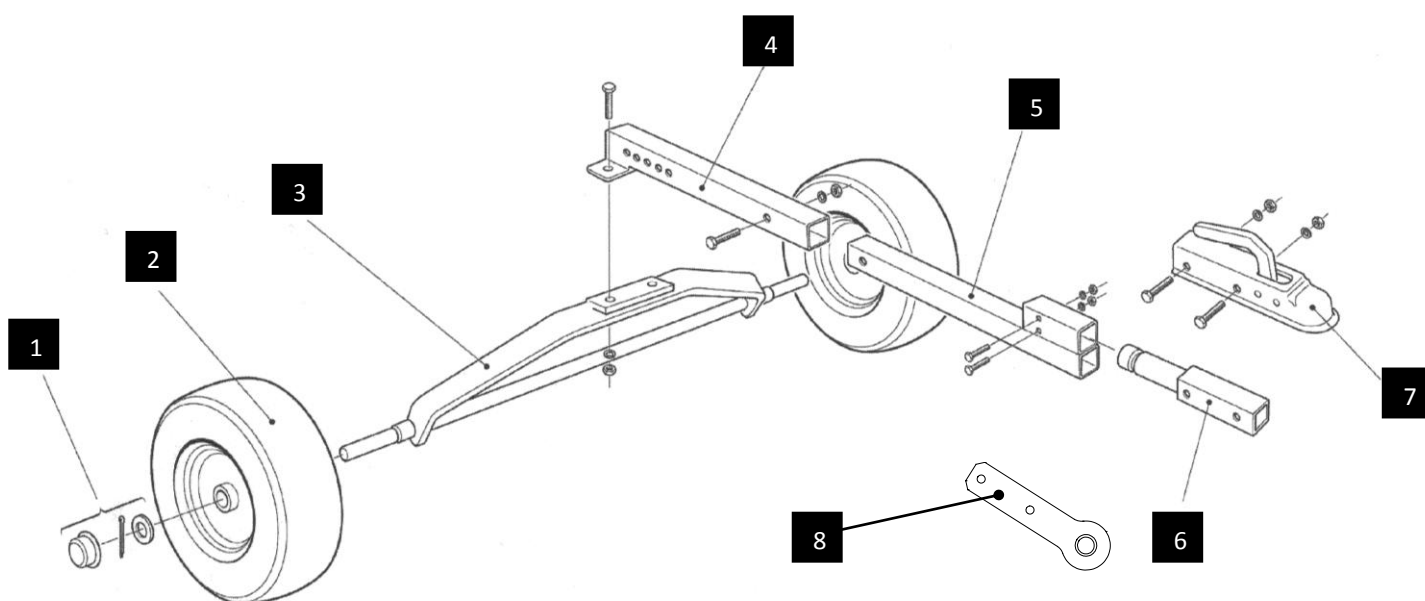

Assembly

- Bolt item 3 (axle assembly) to item 4 (rear of draw bar) using 2 x M12 x 35 bolts and nuts.
- Insert the stub axles of item 3 into the wheel centres of item 2 (wheel assembly) and secure using pin and 'R' clip, add centre caps.
- Fix item 7 (ball assembly or clevis hitch as required) into item 6 (front of drawbar) securing with 2 x M10x80 bolts and nuts.
- Slide item 6 (swivel part of drawbar) onto item 5 using 2 x M12 x 80 bolts and nuts.

Fitting the Spreader

Insert the SnowEx mounting bracket into the rear drawbar (item 4), securing with the hitch pin and clip (part no D4136 supplied with the SnowEx spreader).

The rear drawbar of the TLR-275 has four holes provided to allow adjustment forward and backward to adjust the weight distribution upon the TLR-275 to ensure that optimal draw bar weight of the vehicle is not exceeded, please refer to the tow vehicles instructions for details of the optimum loadings.

Never remove the TLR-275 and spreader from the tow vehicle with material in the hopper as it may be unstable and possibly cause injury!

SnowEx TLR-275 Trailer Hitch

For use with the following SnowEx models only:-

- SP-375
- SP-100
- SP-325
- US-100
- US-200
- SP-575
- SP-1575

The TLR-275 is designed for use with ATV's utility vehicles and other small tow speed vehicles in NON high way applications.

Maximum operating speed when operating the TLR-275 must not exceed 20mph, weight loading must not exceed 250 kg.

The spreader in use with the TLR-275 should only be loaded with spreading material when hitched to a towing vehicle, failing to do this may result in the spreader tipping over which will risk damage and or personnel injury.

When towing the TLR-275 care must be taken when turning sharply, especially on wet or icy surfaces or on snow. Turning sharply can cause a loss of control, especially at speed.

Maintenance

Regularly grease the wheel pivots and the moving parts of the towing ball hitch.
Check tyres for damage and keep inflated to 15 PSI.

Always wash SnowEx equipment thoroughly after contact with corrosive substances.